



MODULAR CONSTRUCTION SYSTEMS

***THE ONLY WAY
TO BUILD[®]***





Reach New Heights in Modular Construction

When you build with Z Modular®, you have access to everything you need to envision greater projects—and to complete them with greater business results. Whether you're a building owner, developer, engineer, architect or construction firm, you'll be amazed at what you can now achieve with modular construction.

Stronger & Taller

Ability to use highest-quality materials

Full code compliance

Improved seismic performance

No risk of misalignment during shipping

Greater height capabilities (30 or more stories)

Fire-rated, noncombustible building due to steel frames and studs

Faster & Smarter

Immediate access to all materials at a lower cost through our extended supply chain

No weather-related slowdowns (up to 95% factory completion)

Lower build-out and erection costs

50% faster project completion
(site work happens during module construction)

Faster occupancy and ROI

Greener, Too!

Framing made of steel, one of the world's most recycled materials

Less material waste due to factory-controlled construction

Less site disturbance

Greater flexibility and module reuse as needs change

Improved air quality inside finished modules
(no trapped moisture)

Fast Fit-out and Build-out



The Revolutionary VectorBloc™

The steel VectorBloc modular connection system forms strong modular frameworks with extremely precise tolerances — allowing you to stack taller than has ever been possible in modular construction. You can reduce the cost of design, coordination, fabrication and building assembly by concentrating the load-bearing and connection functions on a standard, scalable, precision, pre-engineered component that's 100% North American made, and assembled in common fixtures by all suppliers to a project.

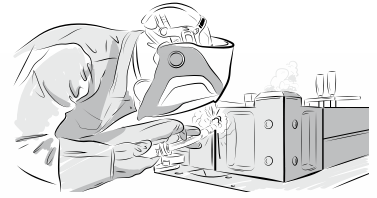

*Fabricators weld the
VectorBloc into place.*

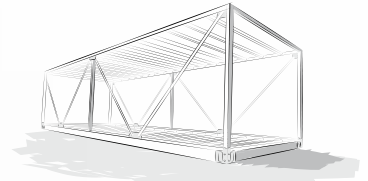

Modular frames take shape.

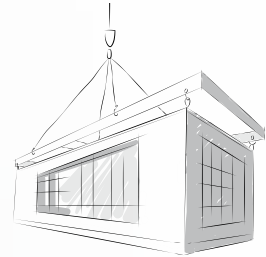

*MEP systems, walls and
glass are added.*

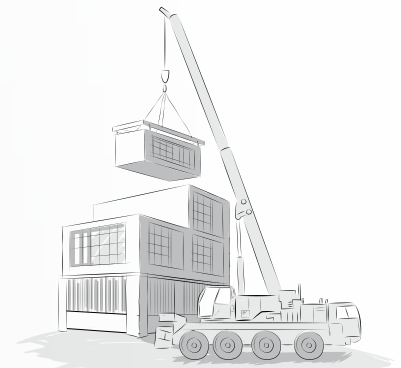

Modules easily stack on-site.



The building is complete.

Adding Value at Every Step

As part of Zekelman Industries, we leverage our industry-leading construction and material production resources on your behalf — streamlining the entire process. We're committed to extending our legacy of customer-focused service, so you can depend on us to deliver.

DESIGN & ENGINEERING

We'll go above and beyond the norm to support your team throughout the full construction process. From initial design, structural engineering and MEP system design to drafting and specification development, we're there to ensure superior building performance. We'll even help you convert an existing design from stick construction to modular, so you can imagine the possibilities!

*Economic construction
at any scale*

FABRICATION SERVICES

Our VectorJig precision fixture and VectorBloc connection system make it quick and easy to produce accurate module frames — in our facility or yours. We'll draw upon our 14 manufacturing facilities and our relationships with key suppliers and partners to provide all the necessary building materials for fast fit-out.



*Modules produced by
different suppliers utilizing
the VectorBloc connection
are fully compatible*

OUTFITTING & CONSTRUCTION

Our highly skilled tradespeople fit out each module and ship to your site in less time than traditional construction. We'll oversee the entire building erection process according to your schedule, stacking modules quickly and easily.



*The VectorBloc system forms
strong, uniform frameworks*

Accurate framing leads to MEP systems and fixtures that always fit

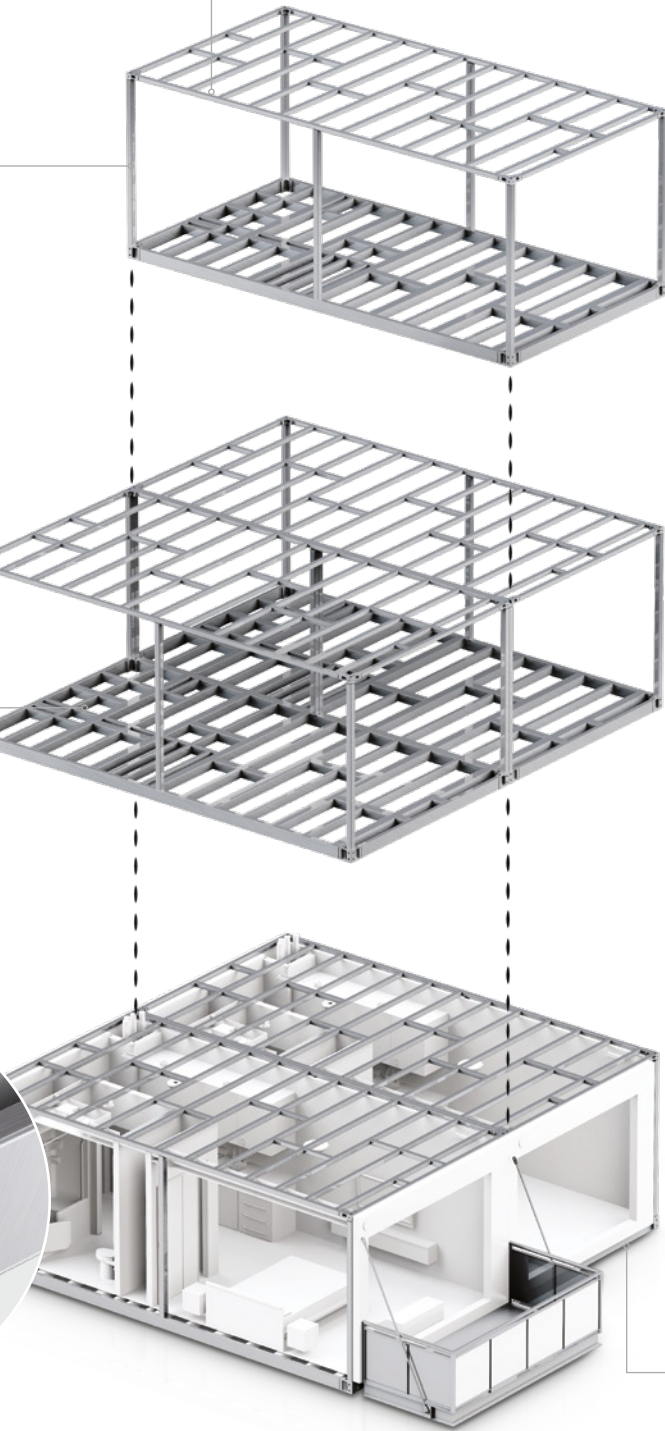

KEY APPLICATIONS

- Multifamily residential
- Data centers
- Low- and high-rise commercial buildings
- Hotels
- Dormitories
- Hospitals and clinics
- Energy and chemical facilities
- ...and more

Tight tolerances (+0", -1/16") ensure even stacking



227 West Monroe Street
Suite 2600
Chicago, IL 60606
800.733.5606
info@z-modular.com
z-modular.com



Corporate Office
227 West Monroe Street
Suite 2600
Chicago, IL 60606
312.275.1600
info@zekelman.com
zekelman.com

About Z Modular

Z Modular, a division of Zekelman Industries, is a one-stop shop for modular construction products and services. Z Modular helps construction companies, building owners and developers build bigger and better than ever before, with exceptional time and capital savings.

For more information, contact Z Modular at:
800.733.5606 or **info@z-modular.com**
Or, visit our website at z-modular.com

Follow us on:



twitter.com/ZekelmanInd



linkedin.com/company/zekelman-industries



youtube.com/ZekelmanIndustries